

## TILING WITH THIN AND LARGE FORMAT TILES

- Guarantees safe laying of thin elements
- Ensures high resistance to compression
- Suitable for renovation work
- Reduces operation times
- System with very low VOC emissions, improves the quality of air and increases the level of health protection for operators

### SUBSTRATE

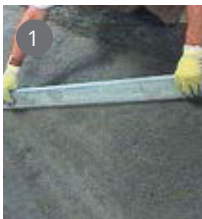

#### Keracem® Eco

Certified, eco-friendly, hydraulic, normal-setting and rapid-drying mineral binder for high-performance screeds and heat-radiant slabs.

### SUBSTRATE LEVELLING



#### Keratech® Eco R10

Certified, extra fast-acting, eco-friendly, mineral selflevelling product for the high-performance, smooth finishing of irregular substrates.

**Coverage ≈**  
**1.6 kg/m<sup>2</sup> per mm of thickness**

### WALL LEVELLING

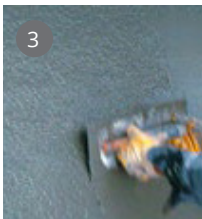

#### Keralevel Eco LR

Certified, fast-acting, eco-friendly, mineral levelling product for the high-performance, high-thickness correction of irregular substrates.

**Coverage**  
**≈ 1.3 kg/m<sup>2</sup> per mm of thickness**

### TILE LAYING

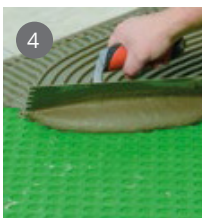

#### H40® Gel

Standard setting, multipurpose Gel-Adhesive, structural, flexible, thixo & fluid. For tiles and stone of all types and formats.

**Coverage**  
**Grey ≈ 1.3 kg/m<sup>2</sup> per mm of thickness**  
**White ≈ 1.2 kg/m<sup>2</sup> per mm of thickness**

### GROUTING

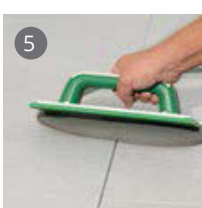

#### Fugabella® Color

Decorative Resina-cemento® (resin-cement) for grouting of ceramic and porcelain tiles, mosaic and natural stone in a 50-colour design range. Green product for bio-building.

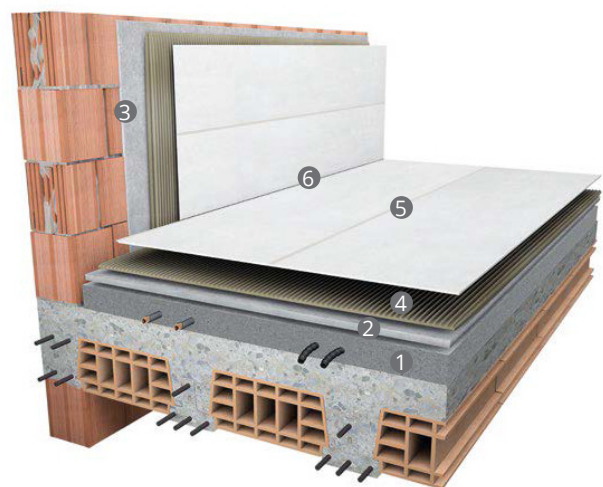

### EXPANSION JOINTS

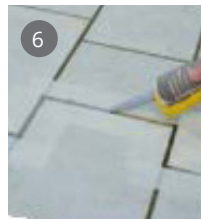

#### Silicone Color

Decorative sealant for tiles and mosaic in 50 design colours. Green product for bio-building.