

TILING TO HEATED SCREEDS

- Specifically for cancelling out cracks and joints in the substrate
- Uncoupling system to compensate for hygrometric shrinkage stresses
- Practical and fast, immediately accessible to foot traffic
- Guarantees safe laying in difficult conditions
- System with very low VOC emissions, improves the quality of air and increases the level of health protection for operators

SUBSTRATE

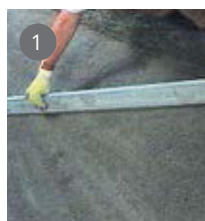

Keracem® Eco

Certified, eco-friendly, hydraulic, normal-setting and rapid-drying mineral binder for high-performance screeds and heat-radiant slabs.

ANTI-CRACKING

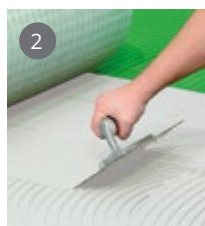

H40® Advanced

Rapid setting, multipurpose gel-adhesive, structural, flexible, thixotropic & fluid. For tiles and stone of all types and formats.

Coverage

Grey $\approx 1.3 \text{ kg/m}^2$ per mm of thickness

White $\approx 1.2 \text{ kg/m}^2$ per mm of thickness



Aquastop Green

Uncoupling and anti-cracking waterproof membrane with high adhesion for balconies, terraces and horizontal surfaces before laying ceramic tiles or natural stone; creates a waterproof surface even when overlaid on substrates that are cracked, have not been perfectly cured or might contain vapour pressure due to residual substrate moisture content.

Coverage

23 m² with 1 roll 20 m

TILE LAYING

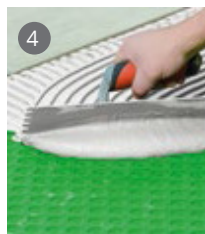

Biogel® Revolution

Rapid setting, multi-purpose, flexible structural gel tile adhesive. Longer workability with accelerated adhesion for bonding even in extreme conditions of all types of material, on any substrate for any use. Eco-friendly.

Coverage

Grey $\approx 1.3 \text{ kg/m}^2$ per mm of thickness

White $\approx 1.2 \text{ kg/m}^2$ per mm of thickness

GROUTING

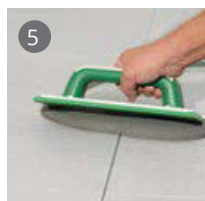

Fugabella® Color

Decorative Resina-cemento® (resin-cement) for grouting of ceramic and porcelain tiles, mosaic and natural stone in a 50-colour design range. Green product for bio-building.

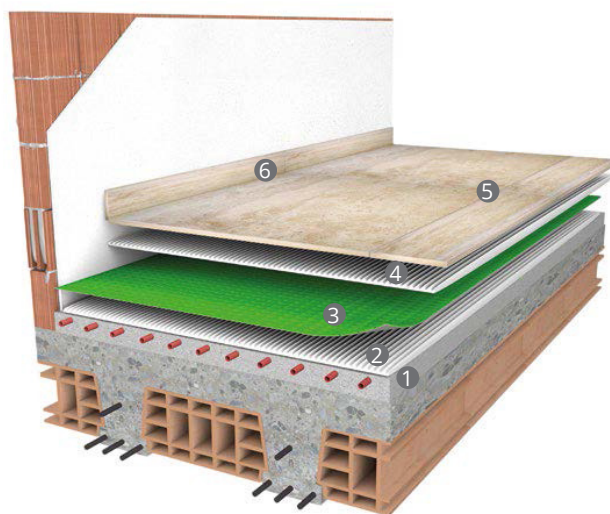

EXPANSION JOINTS

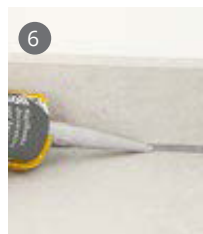

Silicone Color

Decorative sealant for tiles and mosaic in 50 design colours. Green product for bio-building.