

JOURNEY

- Stone effect
- Suitable for both floor & wall applications
- Frost-proof



www.grestec.co.uk | T: 0345 130 2241 | E: sales@grestec.co.uk



FMR30031
LRV: 59



FMR30034
LRV: 57



FMR30033
LRV: 16



FMR30030
LRV: 12



FMR30036
LRV: 19



FMR30035
LRV: 41

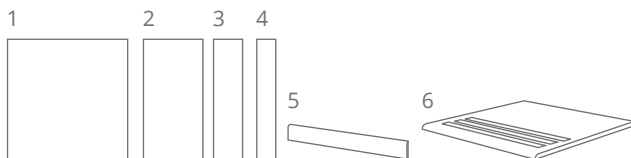

| | SIZE (mm) | THICKNESS | FINISHES | | |
|---|-------------------|-----------|-----------|----------|------------|
| 1 | 600x600 | 10.5mm | NAT (R10) | STR (R9) | AS (R12/C) |
| 2 | 300x600 | 10.5mm | NAT (R10) | STR (R9) | AS (R12/C) |
| 3 | 150x600 | 10.5mm | NAT (R10) | - | - |
| 4 | 100x600 | 10.5mm | NAT (R10) | - | - |
| 5 | 90x600 SKIRTING | 10.5mm | NAT (R10) | STR (R9) | - |
| 6 | 300x300 STEPTREAD | 10.5mm | NAT (R10) | STR (R9) | - |





LRV and PTV values can vary batch to batch, please contact for advice.
Swatch colours may vary, samples should be requested.

Find us on:

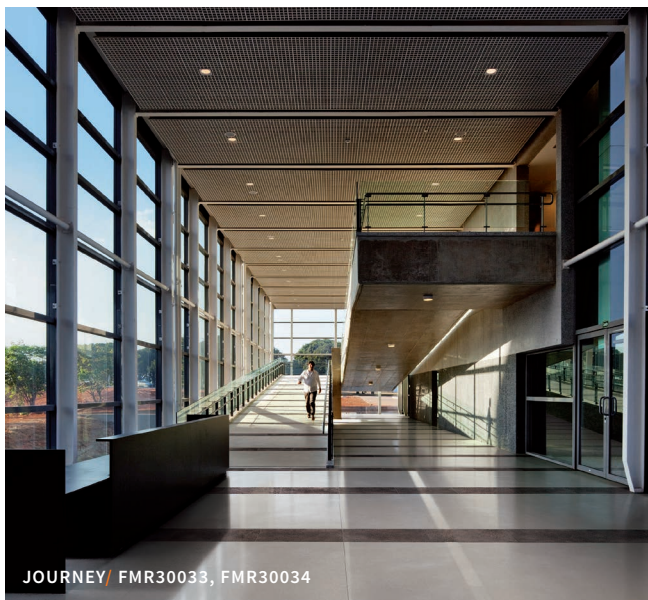

www.grestec.co.uk | T: +44 (0)345 130 2241 | E: sales@grestec.co.uk



LRV and PTV values can vary batch to batch, please contact for advice.
Swatch colours may vary, samples should be requested.
Find us on:    



www.grestec.co.uk | T: +44 (0)345 130 2241 | E: sales@grestec.co.uk

TECHNICAL SPECIFICATION

| TECHNICAL CHARACTERISTIC | STANDARD | AVERAGE VALUES |
|---|--------------|---|
| Water absorption | ISO 10545-3 | 0.04% |
| Sizes | ISO 10545-2 | 0.2% - Length and width 2% - Thickness 0.2% - Linearity 0.2% - Wedging 0.2% - Warpage |
| Bending strength | ISO 10545-4 | >55N/mm ² |
| Deep abrasion resistance | ISO 10545-6 | 120mm ³ |
| Coefficient of linear thermal expansion | ISO 10545-8 | 6.5x10 ⁻⁶ /°C |
| Frost resistance | ISO 10545-12 | Resistant |
| Resistance to chemical products | ISO 10545-13 | Unaffected |
| Stain resistance | ISO 10545-14 | Class 5 |
| Resistance to light | DIN 51094 | No change in brightness or colour |
| Slip resistance (Shod) | DIN 51130 | Natural - R10 Structured - R9 Anti-slip- R12/C |

CLEANING + MAINTENANCE ADVICE

INITIAL WASHING

The initial washing is fundamental for good treatment results. The initial washing is aimed at removing any laying residues and building grime.

| | |
|-----------|---|
| Product | Deterdek (1:5 diluted in water) |
| Coverage | Deterdek (5 l per 100m ²) |
| Equipment | Single-disc professional floor cleaner, liquid vacuum cleaner and cloth |
| Procedure | <ul style="list-style-type: none"> After the floor is swept and soaked with water, spread the diluted Deterdek onto the floor. Then scour with single-disc professional cleaner Vacuum the residue, rinse the floor well and then mop with a liquid vacuum cleaner or a cloth. |

ROUTINE MAINTENANCE

The aim of the routine maintenance is to remove dirt and scuff marks. Must be carried out regularly.

| | |
|-----------|---|
| Product | Filacleaner (Diluted 1:50 in warm water) |
| Equipment | Cloth or mop (For large areas the use of a cleaning machine is recommended) |
| Procedure | <ul style="list-style-type: none"> Dilute Filacleaner in warm water Wipe a cloth wet with the solution over the floor Rinse the floor in case of concentrated solutions of Filacleaner |

SPECIAL MAINTENANCE

Special maintenance is carried out in case of very stubborn dirt, when the routine maintenance is not enough to restore the original look of the surface.

| | |
|-----------|---|
| Product | Fila PS/87 (1:5 diluted in water) |
| Coverage | 5 l per 100m ² (when diluted 1:5) |
| Procedure | <ul style="list-style-type: none"> Dilute Fila PS/87 in 1:5 in water Apply to the floor previously soaked with water and leave for a few minutes Scrub with a single disc professional cleaner Mop up residue with a liquid vacuum cleaner or cloth |

LRV and PTV values can vary batch to batch, please contact for advice.

Swatch colours may vary, samples should be requested.

Find us on:    

