

AMANO



Inspired by the timeless beauty of marble, Amano combines various formats with colours and veining inspired by precious marbles.



V3 high shade variation

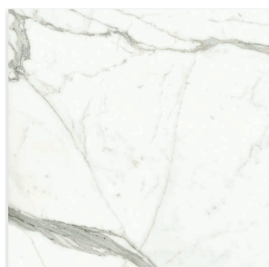
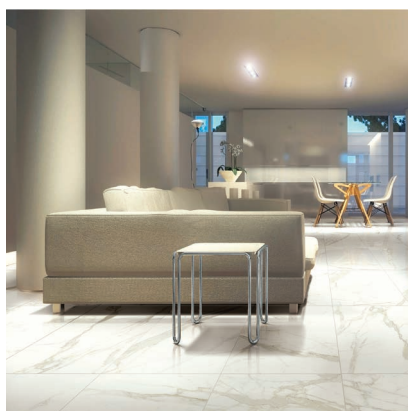

POG38650

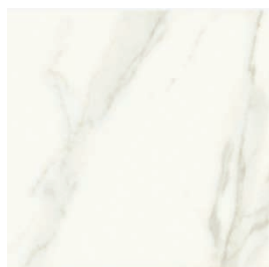

POG38651

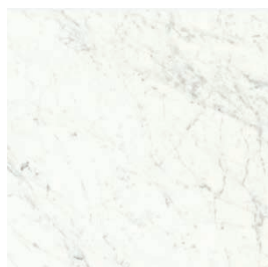

POG38652

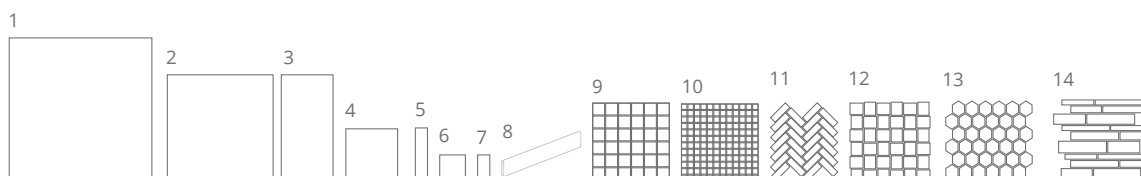

	SIZES (mm)	> <	FINISHES	
1	800x800	11mm	NAT (R9)	POL
2	600x600	9.5mm	NAT (R9)	POL
3	300x600	9.5mm	NAT (R9)	POL
4	300x300	9.5mm	NAT (R9)	POL
5	75x300	9.5mm	NAT (R9)	POL
6	150x150	9.5mm	NAT (R9)	POL
7	75x150	9.5mm	NAT (R9)	POL
8	70x800 / 70x600 SKIRTING	9.5mm	NAT	POL
9	50x50 MOS on 300x300 MESH	9.5mm	NAT (R9)	POL
10	25x25 MOS on 300x300 MESH	9.5mm	NAT (R9)	POL
11	105x270 HERRINGBONE MOS on 300x300 MESH	9.5mm	NAT (R9)	POL
12	45x52 WOVEN RECTANGLES on 300x300 MESH	9.5mm	NAT (R9)	POL
13	52x52 HEXAGON MOS on 300x300 MESH	9.5mm	NAT (R9)	POL
14	MURETTO on 300x300 MESH	9.5mm	NAT (R9)	POL

LRV and PTV values can vary batch to batch, please contact for advice.
Swatch colours may vary, samples should be requested.

Find us on:



www.grestec.co.uk | T: +44 (0)345 130 2241 | E: sales@grestec.co.uk



LONDON STUDIOS

Grestec has its own Tile Studios in London where architects and designers can visit to discover the latest tile ranges and concepts.

Full of new and existing collections suitable for all situations; commercial, retail and residential. Our studio spaces are an excellent environment for ideas, solutions and project discussions, with plentiful samples to take away immediately or simply order for next day delivery. Further details can be found on our website.

STUDIO 329 (APPOINTMENT ONLY)
Business Design Centre, 52 Upper Street,
Islington, London, N1 0QH

POP-UP STUDIO (UNMANNED/ WALK-INS)
The Building Centre, 26 Store Street,
London, WC1E 7BT



TECHNICAL DATA SHEET - ISO 10545 AVERAGE VALUES

2	Sizes	Conforms	9	Resistance to thermal shock	Resistant
3	Water absorption	Conforms	12	Frost resistance	Resistant
4	Bending strength	Conforms	13	Chemical resistance	Resistant
6	Resistance to deep abrasion	128 mm ³	14	Stain resistance	Conforms
8	Coefficient of linear thermal expansion	9x10-5xC-1		Slip resistance DN 51130/ DN 51097	R9

SUSTAINABILITY INFORMATION



CLEANING + MAINTENANCE ADVICE

INITIAL WASHING

The initial washing is fundamental for good treatment results. The initial washing is aimed at removing any laying residues and building grime.

Product: Deterdek

ROUTINE MAINTENANCE

The aim of the routine maintenance is to remove dirt and scuff marks. Must be carried out regularly.

Product: Cleaner Pro

SPECIAL MAINTENANCE

Special maintenance is carried out in case of very stubborn dirt, when the routine maintenance is not enough to restore the original look of the surface.

Product: Fila PS/87

Please see www.filasolutions.com for methods of use, dilution and coverage.

