

# Raised Flooring Advice

Raised outdoor floors exploits the conventional system of floating or raised floors. With this laying system, all the pipes and wiring systems are laid beneath the tiled surface and can be inspected at any time. It offers instant accessibility, by allowing the lifting and removal of the slabs.

A slope of  $\geq 1.5\%$  and a maximum laying height of 10 cm is recommended.

## ADVANTAGES OF RAISED FLOORING FROM EXTREME 20

- Easy to install even without adhesives or filler
- Easy to clean due to the lack of adhesives and filler
- Ideal for paving outdoor installations
- High tensile strength; stress-resistant
- Good drainage, facilitates the flow of water and rainfall, eliminating harmful stagnation
- Highly resistant to changes in temperature;
- Weather resistant
- Frost and fire-resistant
- Removable and reusable
- Easily inspected and functional, allows installation and maintenance of cabling and pipework

## USES



Residential Areas



Commercial Areas

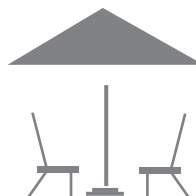

Terraces



Garden, courtyard  
or patio

# Raised Flooring Advice/ installation

## FIXED SUPPORT

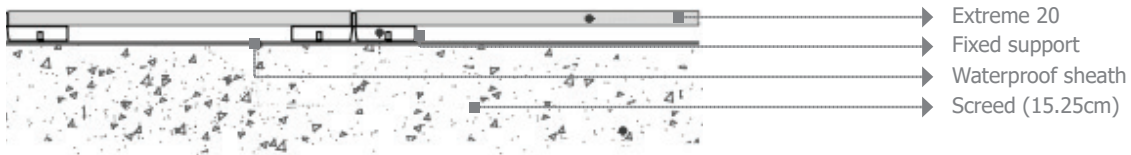

## ADJUSTABLE SUPPORT

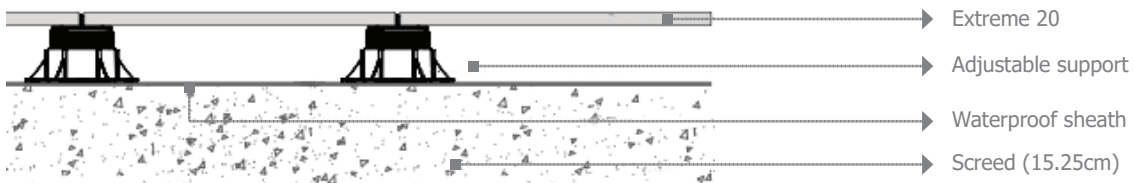

## INSTALLATION GUIDE

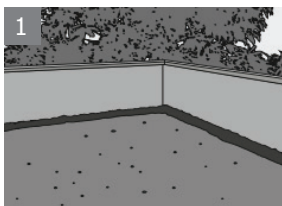

Sub-bed must be fully waterproofed.



Prior to laying, ensure the sub-bed is cleaned carefully.



It is advisable to begin laying from a corner.

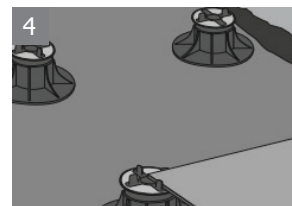

Place supports in relation to the dimensions of the slab.

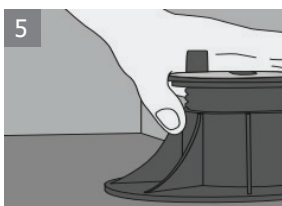

MAX laying height of 100mm is recommended.

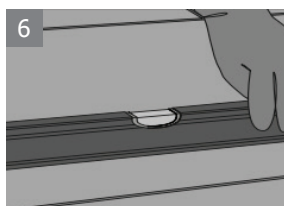

During installation, verify the levelling of the laid slabs (>1%).



To adjust the supports, use an adjustment wrench

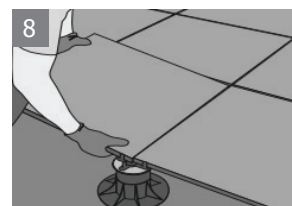

Throughout installation, always check that the joint line is constant

# Raised Flooring Advice / types of supports

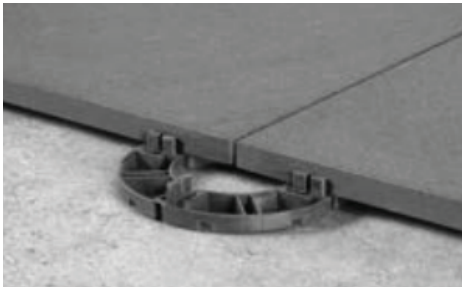

## FIXED SUPPORT

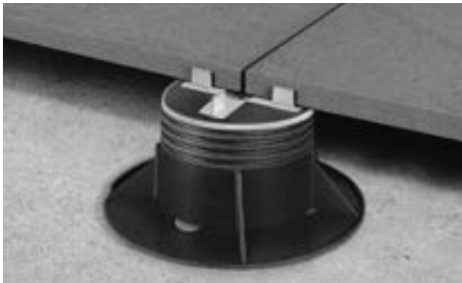

SUPPORT	CODE	HEIGHT
	CP005	12MM
	CP006	15MM
	CP007	20MM

## ADJUSTABLE SUPPORT



SUPPORT	CODE	HEIGHT
	CP049	25-40MM
	CP050	40-70MM
	CP062	60-100MM

## SELF-LEVELLING SUPPORT





SUPPORT	CODE	HEIGHT
	CP085	37.5-50MM
	CP094	50-75MM
	CP103	75-120MM

## LEVELLING DISC



HEIGHT: 3mm

# Raised Flooring Advice

Size (mm)	Up to 2 cm	2-10 cm	10-30 cm	30 - 50 cm
600x600 4 supports per slab 	4 supports (3,4 pc/sqm)	Recommended 5 supports (7 pc/sqm)	4 supports + Glass fibre net (3,4 pc/sqm)	4 supports + Galvanised steel sheet (3,4 pc/sqm)
600x1200 6 supports per slab 	6 supports (3,4 pc/sqm - 600x1200) (6,0 pc/sqm - 450x900)	6 supports + Glass fibre net (3,4 pc/sqm - 600x1200) (6,0 pc/sqm - 450x900)	6 supports + Galvanised steel sheet (3,4 pc/sqm - 600x1200) (6,0 pc/sqm - 450x900)	6 supports + Galvanised steel sheet (3,4 pc/sqm - 600x1200) (6,0 pc/sqm - 450x900)
300x1200 6 supports per slab 	6 supports (7 pc/sqm)	6 supports + Galvanised steel sheet (7 pc/sqm)	6 supports + Galvanised steel sheet (7 pc/sqm)	6 supports + Galvanised steel sheet (7 pc/sqm)